

BP-TMV-38C

BP-TMV-38C-CBT

3/8" Compression

Thermostatic Mixing Valve

Installation Instructions

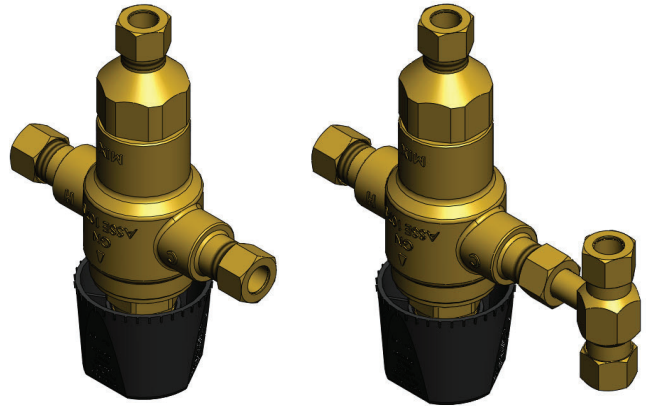

Models BP-TMV-38C and BP-TMV-38C-CBT are thermostatic mixing valves (TMV) that provide 3/8" compression (or 9/16-24UN male thread) inlet and outlet connections. Model BP-TMV-38C-CBT is provided with a cold water bypass tee for endpoint devices requiring dual temperature inlets. These TMV's are tested and certified to ASSE 1070. These TMV's will control and limit the temperature of tempered water to the faucet. They are equipped with an adjustable and lockable means to limit the maximum outlet temperature with the intention of reducing the risk of scalding.

NOTE: Installation should be done by a qualified professional in accordance with these instructions and local plumbing codes. This device is pre-set for approximately 100°F (38°C). This device must be adjusted, verified, and locked to a specific maximum temperature at the time of installation.

TOOLS NEEDED

Adjustable wrench
#2 Phillips Screwdriver
Thermometer

INSTALLATION

1. Flush the connecting piping thoroughly before installing the TMV.
2. Install the TMV as close as possible to the endpoint device (faucet). The TMV can be positioned in any direction. The image above shows the typical installation position.
3. Connect and tighten the Hot and Cold supply hoses to the corresponding Hot (H) and Cold (C) inlets of the TMV. 3/8" tubing can be connected using the ferrules and lock nuts. Flexible supply hoses can be connected to the 9/16-24UN threaded male ends once the ferrule and lock nut are removed.
4. Connect the TMV outlet (MIX) to the inlet of the faucet.
5. If the endpoint device has dual inlets for hot and cold, use BP-TMV-38C-CBT (supplied with the Bypass Tee), or use T&S part # 020862-45 (Bypass Tee) with BP-TMV-38C.
 - a. Install the Bypass Tee on the cold (C) inlet of the TMV.
 - b. Connect the TMV outlet (MIX) to the Hot inlet of the faucet.
 - c. Connect the cold water supply to one side of the Bypass Tee.
 - d. Connect the other side of the Bypass Tee to the Cold inlet of the faucet.

ADJUSTMENT

1. Run hot water thru the faucet until the outlet water temperature stabilizes. Check the temperature with the thermometer (Caution - the outlet temperature may be excessively hot).
2. Loosen the Phillips head screw in the TMV knob approximately 6 turns and pull the knob. It should now turn. If not, loosen the screw a little more until the knob turns.
3. Turn the knob to adjust the outlet water temperature to the desired comfort. It is recommended that the outlet temperature does not exceed 118°F (48°C) to reduce the risk of scalding. To decrease the temperature, turn the knob in the direction of the arrow and "C" as marked on the knob (→C). To increase temperature, turn the knob in the direction of the arrow and "H" as marked on the knob (H←). Allow the water temperature to stabilize. Continue adjustment until the water temperature has stabilized at the desired setting.
4. Push the knob back and tighten the screw to lock the temperature setting.

PERFORMANCE RATING

Minimum Flow Rate: 0.35 GPM

Pressure Drop at Minimum Flow Rate: 0.5 psi

Maximum Pressure: 125 psi

Hot Water Inlet Temperature Range: 120~180°F (49~82°C)

Outlet Temperature Range: 80~120°F (27~49°C)

Outlet Temperature Factory Setting: Approx. 100°F (38°C)

Limited One Year Warranty (Commercial Applications)

T&S warrants to the original purchaser (other than for purposes of resale) that such product is free from defects in material and workmanship for a period of one (1) year from the date of purchase. During this one-year warranty period, if the product is found to be defective, T&S shall, at its options, repair and/or replace it. To obtain warranty service, products must be returned to...

*T&S Brass and Bronze Works, Inc.
Attn: Warranty Repair Department
2 Saddleback Cove
Travelers Rest, SC 29690*

Shipping, freight, insurance, and other transportation charges of the product to T&S and the return of repaired or replaced product to the purchaser are the responsibility of the purchaser. Repair and/or replacement shall be made within a reasonable time after receipt by T&S of the returned product. This warranty does not cover items which have received secondary finishing

or have been altered or modified after purchase, or for defects caused by physical abuse to or misuse of the product, or shipment of the products.

Any express warranty not provided herein, and any remedy for Breach of Contract which might arise, is hereby excluded and disclaimed. Any implied warranties of merchantability or fitness for a particular purpose are limited to one year in duration. Under no circumstances shall T&S be liable for loss of use or any special consequential costs, expenses or damages.

Some states do not allow limitations on how long and implied warranty lasts or the exclusion or limitation of incidental or consequential damages, so the above limitations or exclusions may not apply to you. Specific rights under this warranty and other rights vary from state to state.

Attention California Residents:

WARNING This product can expose you to chemicals including Lead, Chromium (hexavalent compounds) and Phthalates (DEHP) which are known to the State of California to cause cancer and birth defects or other reproductive harm.

For more information go to www.P65Warnings.ca.gov

T&S Brass and Bronze Works, Inc. · 2 Saddleback Cove · P.O. Box 1088 · Travelers Rest, SC 29690
www.tsbrass.com · E-mail: tsbrass@tsbrass.com · Phone (800) 476-4103 · Fax (800) 868-0084

West Coast Sales and Distribution · 4596 Ish Drive · Unit 220
Simi Valley, CA 93063 · Phone (800) 423-0150

098-020944-45 Rev. 0
Drawn TED 04-06-22
Checked GEF 04-07-22
Approved JHB 04-08-22