



# T&S BRASS AND BRONZE WORKS, INC.

2 Saddleback Cove / P.O. Box 1088  
Travelers Rest, SC 29690

Model No.

**020932-45**

Item No.

Travelers Rest, SC: 800-476-4103 • Simi Valley, CA: 800-423-0150 • Fax: 864-834-3518 • www.tsbrass.com

This Space for Architect/Engineer Approval

Job Name \_\_\_\_\_ Date \_\_\_\_\_

Model Specified \_\_\_\_\_ Quantity \_\_\_\_\_

Customer/Wholesaler \_\_\_\_\_

Contractor \_\_\_\_\_

Architect/Engineer \_\_\_\_\_



1/2" NPSM Female Swivel Nut



31 1/2" [800mm] Long Flexible Hose. Stainless Steel Outer Braid on Flexible Portion of Hose

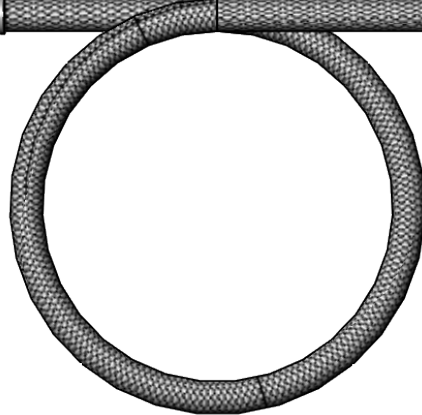

M10 x 1g Male Fitting with O-ring



**Product Specifications:**

1/2" NPSM Female x M10x1 Male Flexible Connector Hose, 31 1/2" Long

**Product Compliance:**

ASME A112.18.6 / CSA B125.6  
NSF 61 - Section 9  
NSF 372 (Low Lead Content)