



Architect/Engineering Specifications:

1.07 GPM spray bugle, polished chrome plated brass body, ball joint swivel with G1/2 male inlet. Certified to ASME A112.18.1/CSA B125.1, NSF 61-Section 9 and NSF 372. 2019 DOE PRSV - Class II compliant.

Job Name _____

Model Specified _____ Quantity _____

Variations Specified _____

Date _____

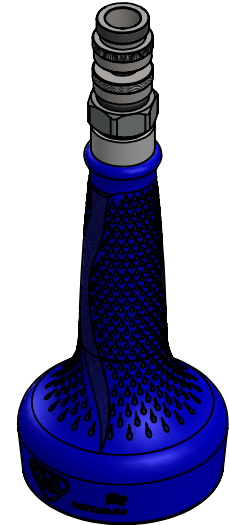
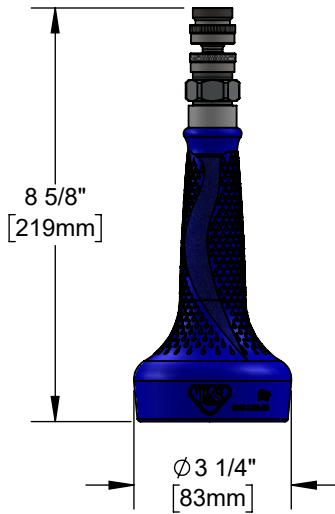

Features & Benefits:

- Chrome plated forged brass body
- 1.07 GPM spray bugle
- Ball joint swivel w/ washer
- G1/2 male inlet
- Heat insulated handle with crush resistant grip
- Material: Polished chrome plated brass body, swivel and insulated rubber grip handle

Product Compliance:

- ASME A112.18.1 / CSA B125.1
- NSF 61 - Section 9
- NSF 372 (Low Lead Content)
- 2019 DOE PRSV - Class II



Warranty: One Year (Limited)

Performance Data:

- Pressure: 20 - 125 psi [1.38 - 8.62 bar]
- Temperature: 40°F - 140°F [4.44°C - °C]
- Flow Rate: 1.07 GPM [4.05 L/min] @ 60 psi [4.14 bar]

