



T&S BRASS AND BRONZE WORKS, INC.
 2 Saddleback Cove / P.O. Box 1088
 Travelers Rest, SC 29690

Model No.
B-1450-01

Item No.

Travelers Rest, SC: 800-476-4103 • Simi Valley, CA: 800-423-0150 • Fax: 864-834-3518 • www.tsbrass.com

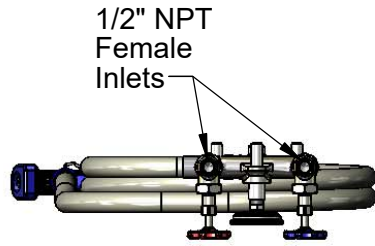

This Space for Architect/Engineer Approval

Job Name _____ Date _____

Model Specified _____ Quantity _____

Customer/Wholesaler _____

Contractor _____

Architect/Engineer _____

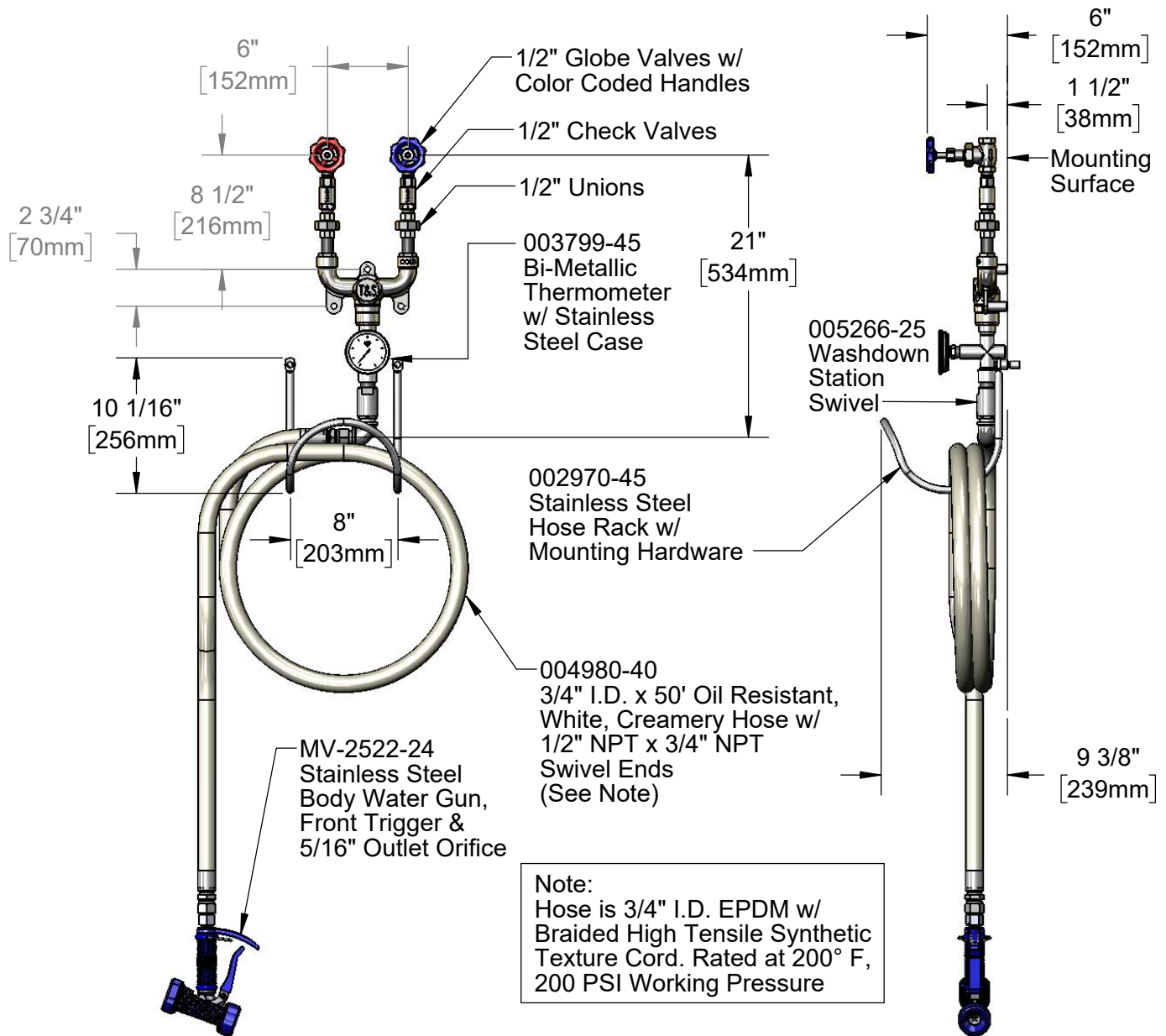

Note:
 Hose is 3/4" I.D. EPDM w/ Braided High Tensile Synthetic Texture Cord. Rated at 200° F, 200 PSI Working Pressure

Product Specifications:
 Hot & Cold Water Washdown Station w/ Thermometer, Mixing Valve w/ 1/2" NPT Inlets, 50' Creamery Hose w/ Water Gun & Hose Rack

Product Compliance:
 NSF 61 Exempt (Non-Potable)



T&S BRASS AND BRONZE WORKS, INC.
 2 Saddleback Cove / P.O. Box 1088
 Travelers Rest, SC 29690

Model No.
B-1450-01

Item No.

Travelers Rest, SC: 800-476-4103 • Simi Valley, CA: 800-423-0150 • Fax: 864-834-3518 • www.tsbrass.com

ITEM NO.	SALES NO.	DESCRIPTION
1	002970-45	Hose Rack w/ Mounting Hardware
2	MV-2522-24	Stainless Steel Water Gun, Front Trigger
3	004980-40	50' of 3/4" Hose w/ Adapters
4	003799-45	Thermometer, Bi-Metallic
5	MV-0771-11C	Mixing Valve
6	006509-25	Spacer, Hoserack

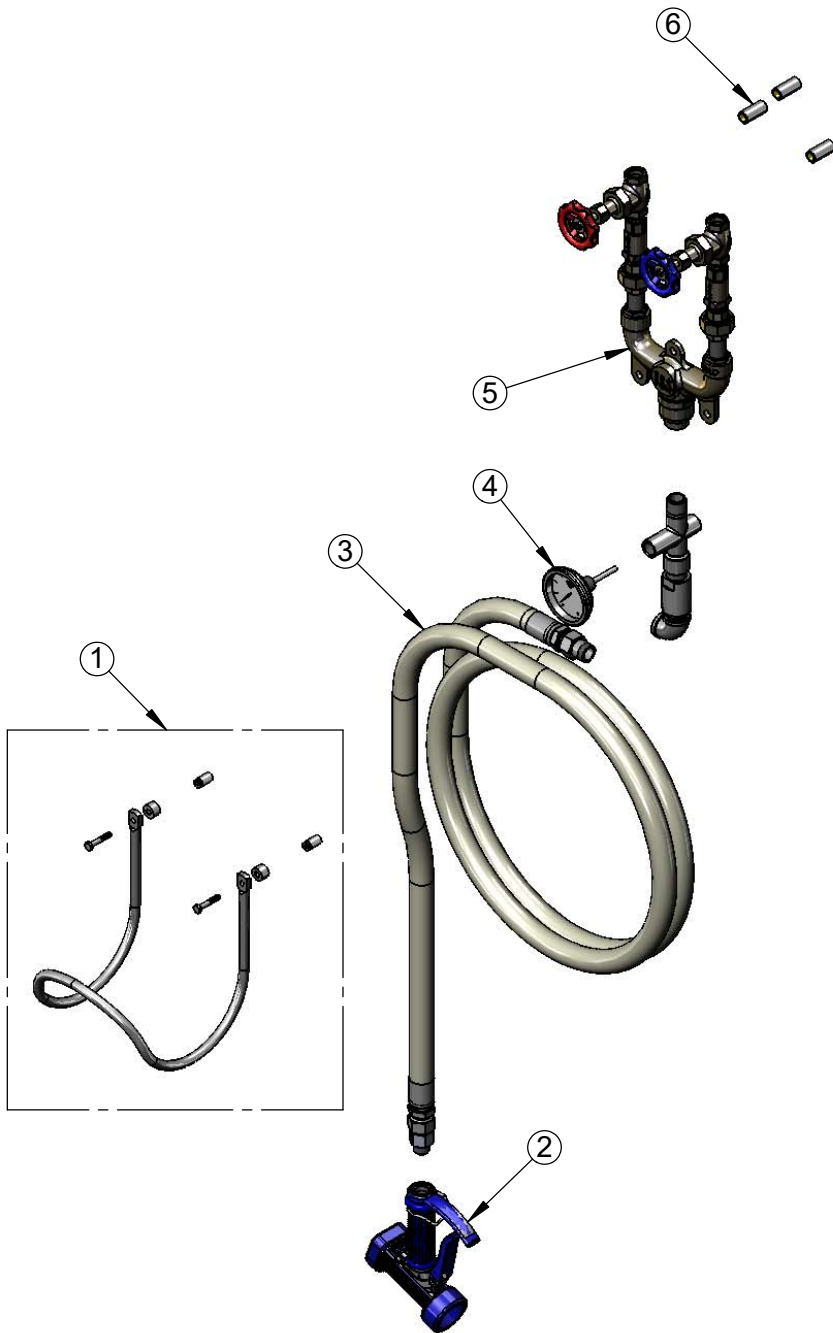

Product Specifications:
 Hot & Cold Water Washdown Station w/ Thermometer,
 Mixing Valve w/ 1/2" NPT Inlets, 50' Creamery Hose w/
 Water Gun & Hose Rack

Product Compliance:
 NSF 61 Exempt (Non-Potable)