



**T&S BRASS AND BRONZE WORKS, INC.**  
 2 Saddleback Cove / P.O. Box 1088  
 Travelers Rest, SC 29690

Model No.  
**MV-1907-12CW**

Item No.

Travelers Rest, SC: 800-476-4103 • Simi Valley, CA: 800-423-0150 • Fax: 864-834-3518 • www.tsbrass.com

This Space for Architect/Engineer Approval

Job Name \_\_\_\_\_ Date \_\_\_\_\_  
 Model Specified \_\_\_\_\_ Quantity \_\_\_\_\_  
 Customer/Wholesaler \_\_\_\_\_  
 Contractor \_\_\_\_\_  
 Architect/Engineer \_\_\_\_\_

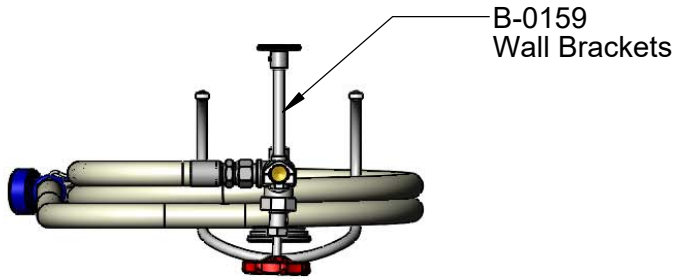

Adjustable from  
 1 1/4" to 6"  
 [32mm to 152mm]

3/4" Supply Piping  
 by Others

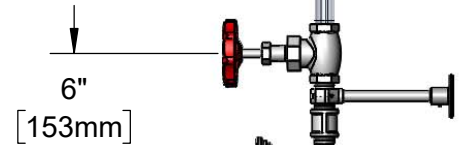

Hose Swivel  
 (Hose not  
 Shown for  
 Clarity )

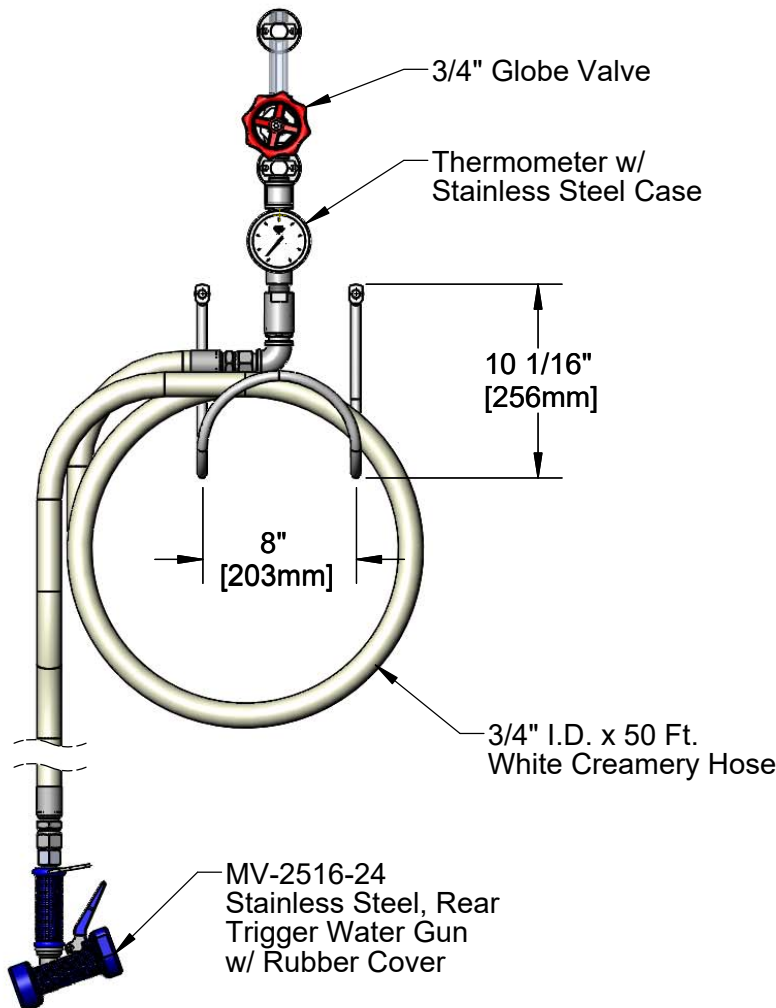
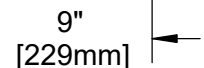

Product Specifications:  
 Chrome Plated Washdown Station w/ 3/4" Inlet, Single Service Valve,  
 Thermometer, 50 Ft. Hose, Stainless Steel Water Gun & Hose Rack

Product Compliance:  
 NSF 61 Exempt (Non-Potable)



**T&S BRASS AND BRONZE WORKS, INC.**  
 2 Saddleback Cove / P.O. Box 1088  
 Travelers Rest, SC 29690

Model No.  
**MV-1907-12CW**

Item No.

Travelers Rest, SC: 800-476-4103 • Simi Valley, CA: 800-423-0150 • Fax: 864-834-3518 • www.tsbrass.com

ITEM NO.	SALES NO.	DESCRIPTION
1	B-0159	6" Wall Bracket
2	006648-25	3/4" Globe Valve
3	003799-45	Thermometer, Bi-Metallic
4	004980-40	50' of 3/4" Hose w/ Adapters
5	MV-2516-24	5/16" Water Gun, Rear Trigger
6	002970-45	Hose Rack w/ Mounting Hardware
7	007252-25	Swivel
8	002721-45	O-Ring

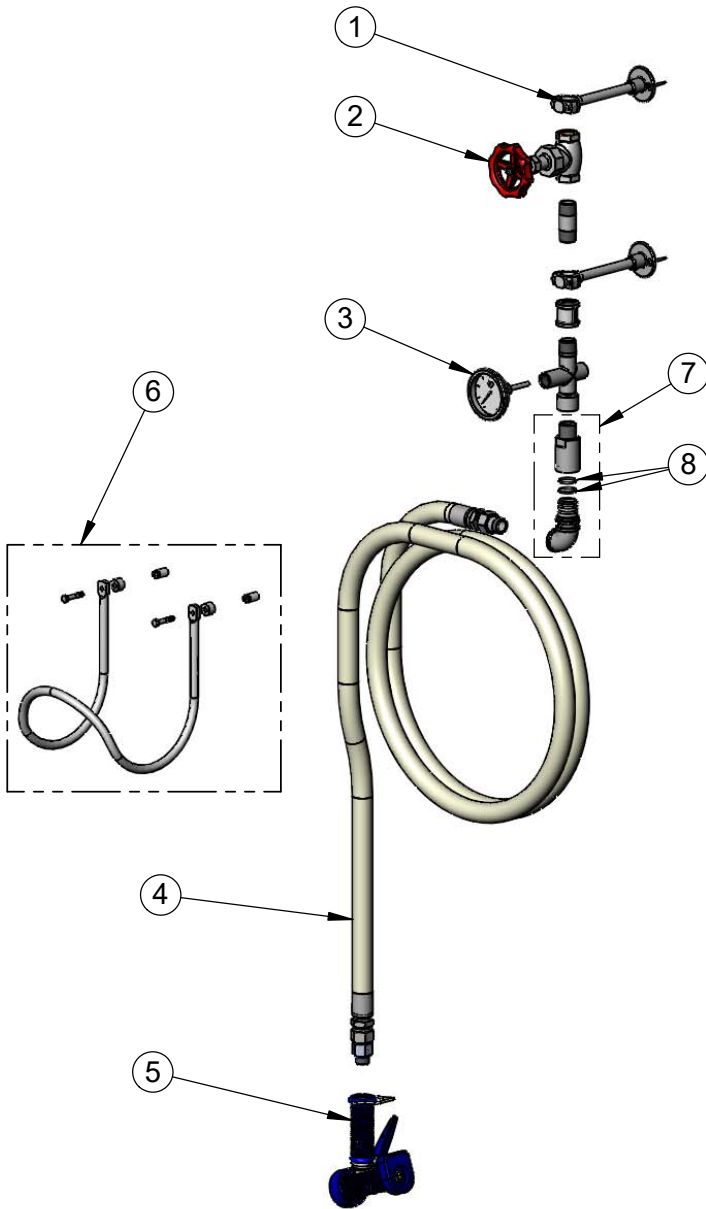

**Product Specifications:**

Chrome Plated Washdown Station w/ 3/4" Inlet, Single Service Valve, Thermometer, 50 Ft. Hose, Stainless Steel Water Gun & Hose Rack

**Product Compliance:**

NSF 61 Exempt (Non-Potable)