



**Architect/Engineering Specifications:**

30" stainless steel flexible hose with 1/2" NPSM female threads, stainless steel ball joint swivel and 1.07 GPM blue insulated sprayer. Certified to ASME A112.18.1 / CSA B125.1, NSF 61 - Section 9, NSF 372. 2019 DOE PRSV - Class II compliant.

Job Name \_\_\_\_\_

Model Specified \_\_\_\_\_ Quantity \_\_\_\_\_

Variations Specified \_\_\_\_\_

Date \_\_\_\_\_

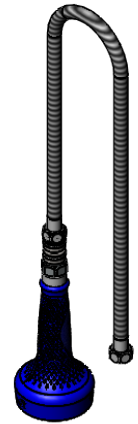
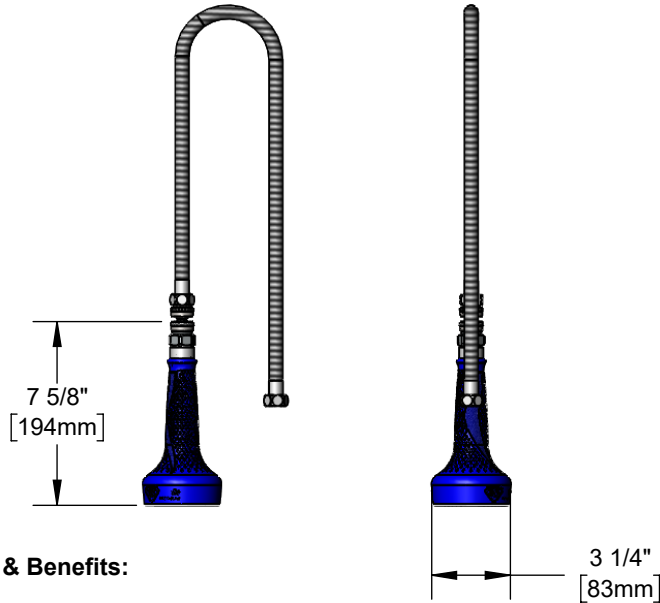

**Features & Benefits:**

- 30" stainless steel flex hose with 1/2" NPSM female threads and washers
- Stainless steel ball joint swivel with washer
- 1.07 GPM blue insulated sprayer with check valve
- Material: Stainless steel hose & ball joint swivel, rubber sprayer & plastic spray face

**Product Compliance:**

- ASME A112.18.1 / CSA B125.1
- NSF 61 - Section 9
- NSF 372 (Low Lead Content)
- 2019 DOE PRSV - Class II



**Warranty:** One Year (Limited)

**Performance Data:**

- Pressure: 20 - 125 psi [1.38 - 8.62 bar]
- Temperature: 40°F - 140°F [4.44°C - 60 °C]
- Flow Rate: 1.07 GPM [ 4.05 l/min] @ 60 psi [4.14 bar]

