

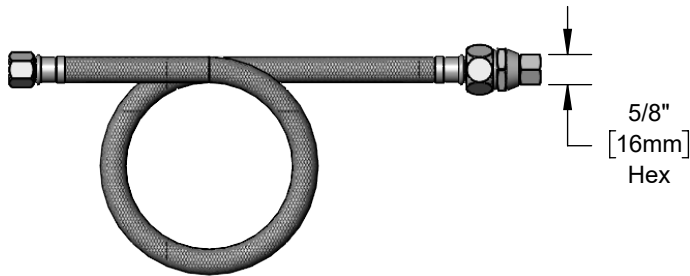

**Architect/Engineering Specifications:**

Flexible stainless steel supply hose, check valve adapter with 3/8" compression female swivel nut inlet and filter washer in swivel nut. Certified to NSF 61-Section 9 and NSF 372.

Job Name	_____
Model Specified	_____
Quantity	_____
Variations Specified	_____
Date	_____

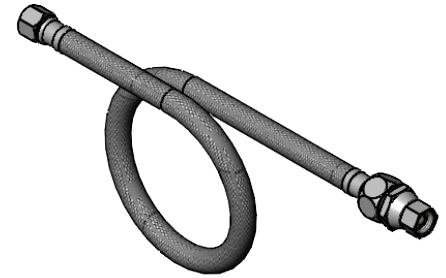

**Features & Benefits:**

- 18" flexible stainless steel hose
- Hose fits EC-3130/3132/3142 electronic sensor faucets
- Chrome plated brass check valve adapter body & swivel nut
- 3/8" compression female swivel nut inlet with filter washer
- 3/8" compression female outlet
- Material: Stainless steel outer braid and chrome plated brass adapter body

**Product Compliance:**

- NSF 61 - Section 9
- NSF 372 (Low Lead Content)



**Warranty:** One Year (Limited)



**Performance Data:**

- Pressure: 20 - 125 psi [1.38 - 8.62 bar]
- Temperature: 40°F - 140°F [4.44 C - 60 C]
- Flow Rate: 2.84 GPM [10.75 L/min] @ 60 psi [4.14 bar]

