

**Architect/Engineering Specifications:**

In-line continuous pressure dual check vacuum breaker with intermediate vent, polished chrome body, 3/8" NPT female outlet and inlet and 3/8" NPT close nipple. Certified to ASME A112.18.1/CSA B125.1, NSF 61-Section 9, NSF 372 and CSA B64.8.

Job Name \_\_\_\_\_  
 Model Specified \_\_\_\_\_ Quantity \_\_\_\_\_  
 Variations Specified \_\_\_\_\_  
 Date \_\_\_\_\_

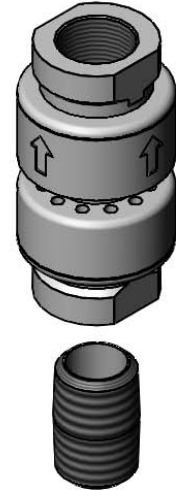
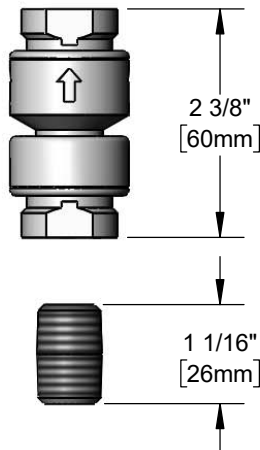
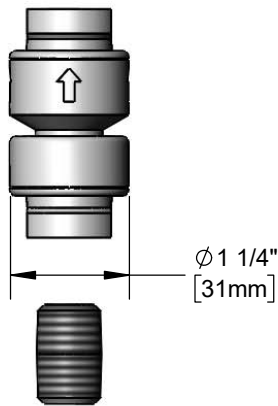

**Features & Benefits:**

- In-line 3/8" continuous pressure dual check vacuum breaker w/ polished chrome plated body
- 3/8" NPT female Inlet and outlet
- 3/8" NPT close nipple included
- Design prevents back siphonage of contaminated water
- Material: Polished chrome plated brass body and nipple

**Product Compliance:**

- ASME A112.18.1 / CSA B125.1
- NSF 61 - Section 9
- NSF 372 (Low Lead Content)
- CSA B64.8 (VB)



**Warranty:** One Year (Limited)

**Performance Data:**

- Pressure: 20 - 125 psi [1.38 - 8.62 bar]
- Temperature: 40 °F - 140 °F [4.44 °C - 60 °C]
- Flow Rate: 7.27 GPM [27.52 L/min] @ 60 psi [4.14 bar]