

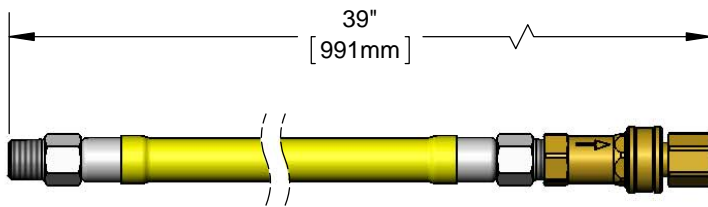

Architect/Engineering Specifications:

36" coated gas appliance connector hose with 3/4" NPT male connections, installation kit, locating devices and quick-disconnect. Certified to ANSI Z21.69/CSA 6.16 and NSF 2.

Job Name _____
 Model Specified _____ Quantity _____
 Variations Specified _____
 Date _____

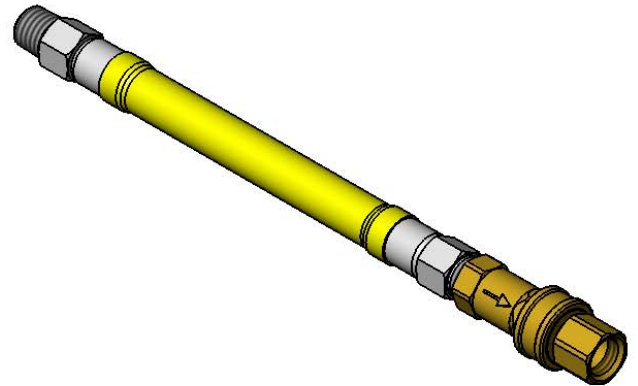

(2) Posi-Set Appliance Locating Devices w/ Mounting Hardware

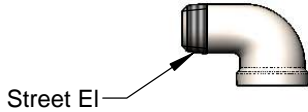
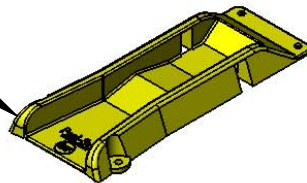

Street El

Installation Kit:

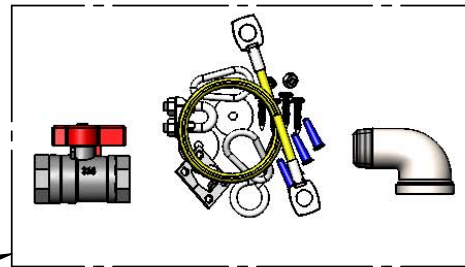

Features & Benefits:

- 36" coated gas appliance connector
- 3/4" NPT male freespun inlet
- 3/4" NPT male freespun outlet
- 3/4" NPT female quick-disconnect
- Street elbow included
- Posi-Set locating devices to maintain position of equipment
- 360° rotatable hex nut rotates completely and freely
- Optimum torsional relief improves safety, increases connector life
- Provides efficient, full gas flow
- Quick-disconnect socket acts as shut-off valve when the plug and socket are disconnected
- Material: Extruded coated stainless steel braids

Product Compliance:

- ANSI Z21.69 / CSA 6.16
- NSF 2
- NFPA 54



Warranty: Five Year (Limited)

Performance Data:

- Gas Pressure: 1/2 psi max
- Temperature: 350° F max w/ Fusible Link Thermal Shut-off
- Capacity: 220,000 BTU / hr min

