

*This Space for Architect/Engineer Approval*

Job Name \_\_\_\_\_ Date \_\_\_\_\_  
 Model Specified \_\_\_\_\_ Quantity \_\_\_\_\_  
 Customer/Wholesaler \_\_\_\_\_  
 Contractor \_\_\_\_\_  
 Architect/Engineer \_\_\_\_\_

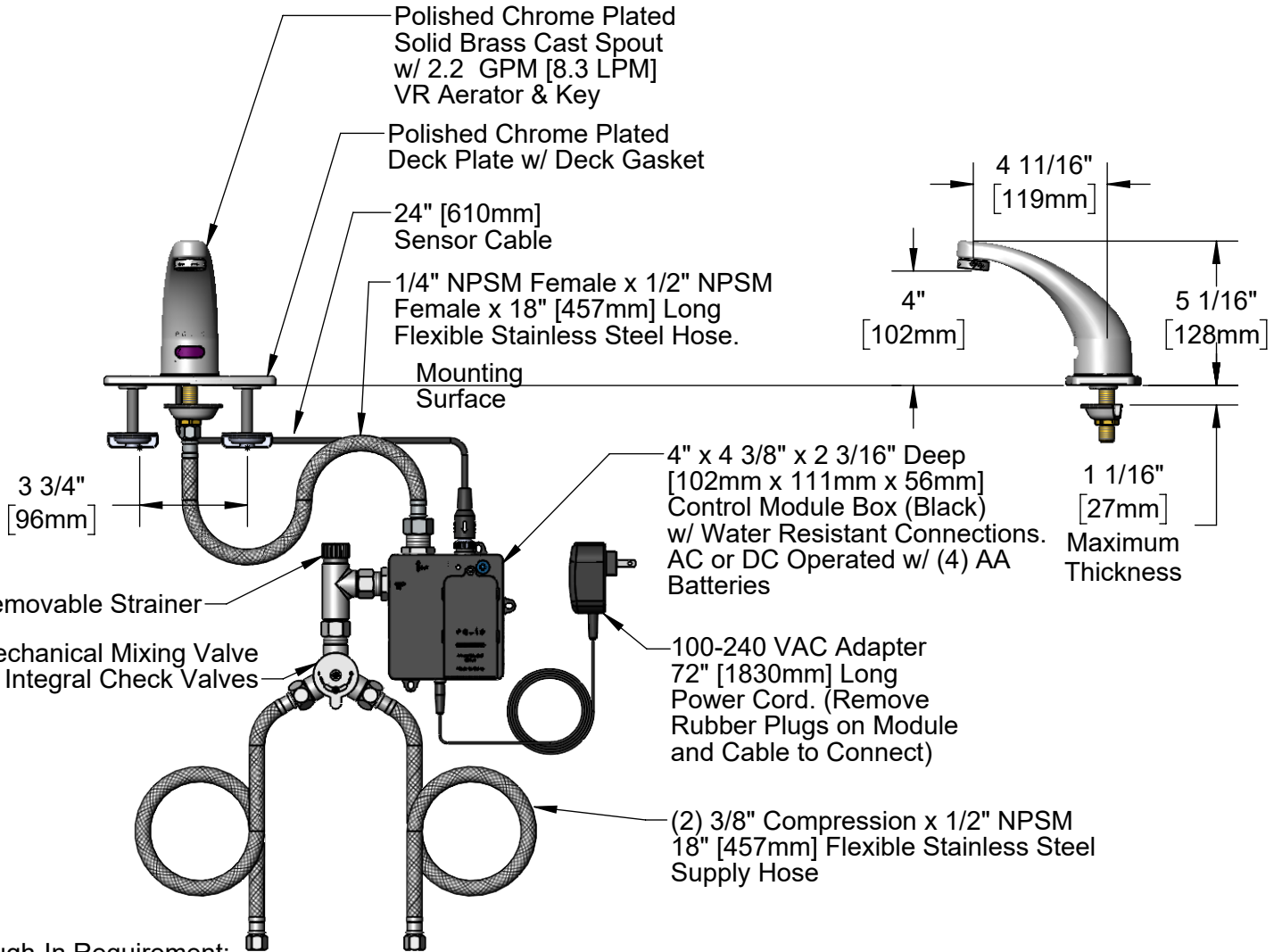

**ADA Compliant**



**Rough-In Requirement:**  
 Ø 1" [25mm] Center Hole  
 (2) Ø 1 1/8" [28mm] Side Holes

Model Number <p style="text-align: center;"><b>5EF-1D-DS-4DP</b></p>	<b>Product Specifications:</b> Electronic Faucet: Cast Brass Single Hole Deck Mount, 4" Deck Plate, 2.2 GPM VR Aerator, Temperature Control Mixing Valve, Check Valves, (2) 18" Flexible Supply Hoses & AC-DC Control Module
<b>Product Compliance:</b> ASME A112.18.1 / CSA B125.1 NSF 61 - Section 9 NSF 372 (Low Lead Content) ANSI A117.1 (ADA) UL 1951	<div style="display: flex; justify-content: space-between; align-items: center;"> <div data-bbox="602 1906 738 1980"> <p>equip Foodservice Accessories</p> </div> <div data-bbox="745 1858 1089 2026"> </div> <div data-bbox="1097 1894 1567 1995"> <p>2 Saddleback Cove, P.O. Box 1088            Travelers Rest, South Carolina 29690            Phone: 800.891.4808 Fax: 800.868.0084            equip.tsbrass.com</p> </div> </div>

ITEM NO.	SALES NO.	DESCRIPTION
1	013433-40	4" Universal Deck Plate, Gasket & Mounting Hardware
2	015425-45	Vandal Resistant Key
3	B-0199-09	VR 2.2 GPM Aerator, 15/16-27 Male w/ Key
* 4	5EF-0004C	Sensor Cable w/Curved Lens
5	016297-45	Inlet Hose, Faucet, 1/2" NPSM-F x 1/4" NPSM-F
6	EC-FILTER	Replacement Filter
* 7	5EF-0001C	equip Control Module (Black)
* 8	5EF-0002C	AC Adapter - US Plug
9	5EF-0005	Supply Hose, 9/16-24 Female x 1/2" NPSM
10	5EF-0006	Temperature Mixing Valve

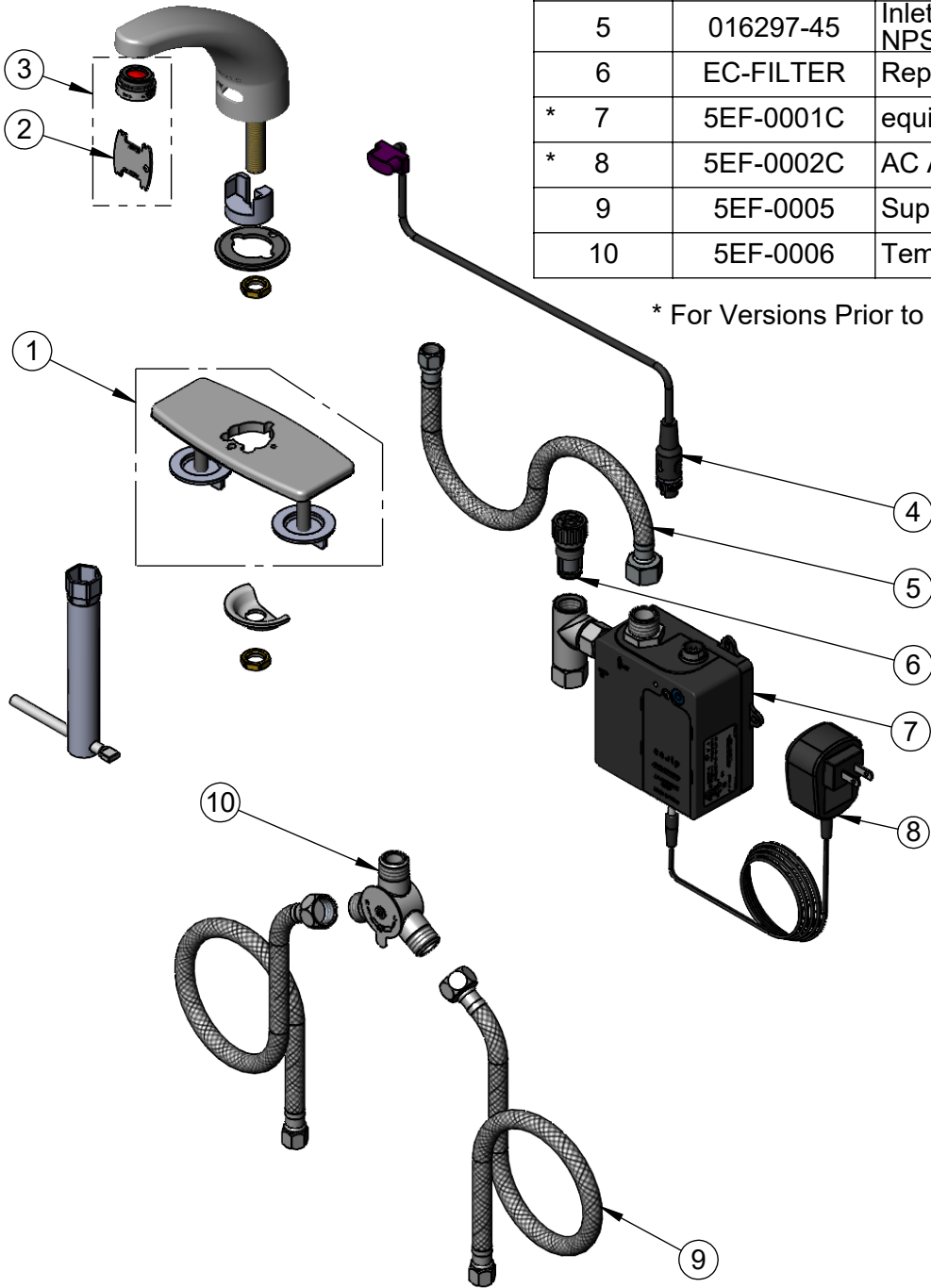

Model Number

**5EF-1D-DS-4DP**

Product Specifications:

Electronic Faucet: Cast Brass Single Hole Deck Mount, 4" Deck Plate, 2.2 GPM VR Aerator, Temperature Control Mixing Valve, Check Valves, (2) 18" Flexible Supply Hoses & AC-DC Control Module

Product Compliance:

ASME A112.18.1 / CSA B125.1  
NSF 61 - Section 9  
NSF 372 (Low Lead Content)  
ANSI A117.1 (ADA)  
UL 1951

equip  
Foodservice  
Accessories

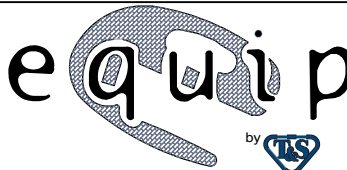

2 Saddleback Cove, P.O. Box 1088  
Travelers Rest, South Carolina 29690  
Phone: 800.891.4808 Fax: 800.868.0084  
equip.tsbrass.com