



**ADA Compliant**

*This Space for Architect/Engineer Approval*

Job Name \_\_\_\_\_ Date \_\_\_\_\_

Model Specified \_\_\_\_\_ Quantity \_\_\_\_\_

Customer/Wholesaler \_\_\_\_\_

Contractor \_\_\_\_\_

Architect/Engineer \_\_\_\_\_

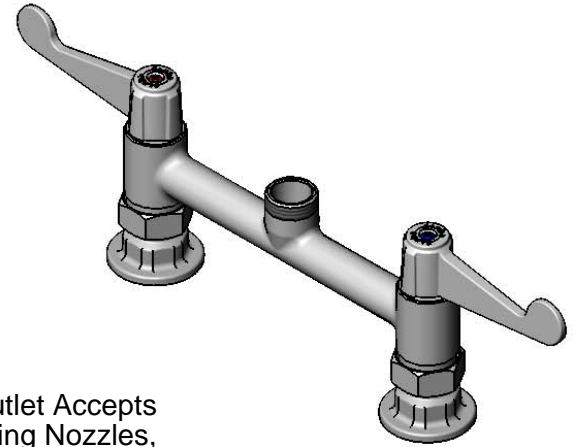
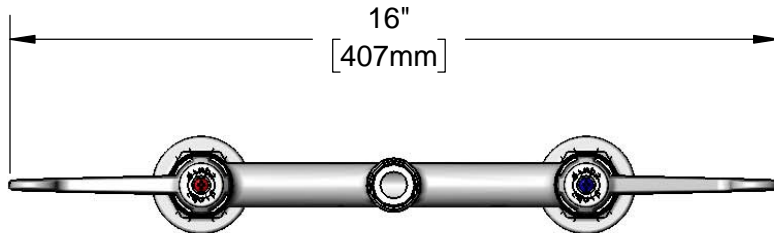

Swivel Outlet Accepts  
Equip Swing Nozzles,  
Rigid Conversion Requires  
014200-45 Lock Washer  
(Sold Separately)

Quarter-Turn Ceramic Cartridges  
& equip 4" Wrist Action Handles  
w/ Color Coded Screws

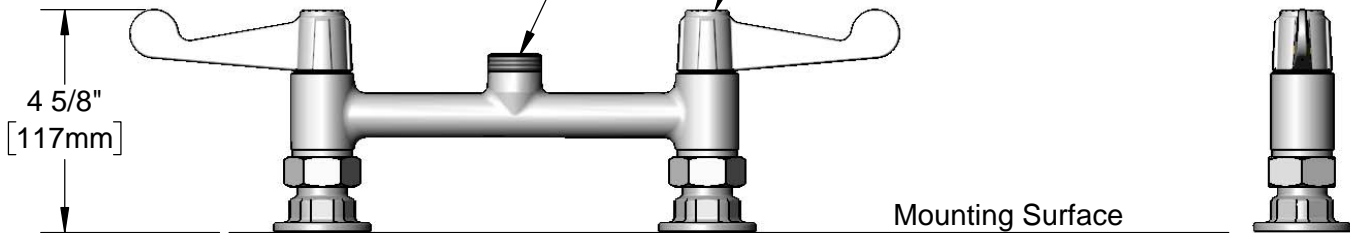

Mounting Surface

8" [203mm]  
Adjustable From  
7 3/4" to 8 1/4"  
[197mm to 210mm]  
Ø 2" [51mm]  
Flanges w/  
1/2" NPT  
Female Inlets

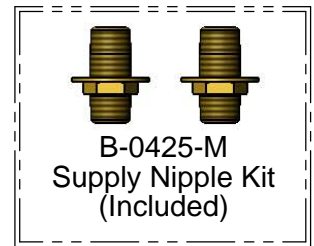

**Rough-In Requirement:**  
(2) Ø 1" [25mm] Mounting Holes

Model Number  
**5F-8DWS00**

Product Specifications:  
**8" Deck Mount Mixing Faucet, Quarter-Turn Ceramic Cartridges,  
Less Swivel Gooseneck w/ equip 4" Wrist Action Handles & 1/2" NPT  
Supply Nipple Kits**

Product Compliance:  
ASME A112.18.1 / CSA B125.1  
NSF 61 - Section 9  
NSF 372 (Low Lead Content)  
ANSI A117.1 (ADA)

equip  
Foodservice  
Accessories



by 

2 Saddleback Cove, P.O. Box 1088  
Travelers Rest, South Carolina 29690  
Phone: 800.891.4808 Fax: 800.868.0084  
equip.tsbrass.com

ITEM NO.	SALES NO.	DESCRIPTION
1	013787-45	equip Quarter-Turn Ceramic Cartridge, RTC
2	5-HDL-W	equip 4" Wrist Action Handle w/ Color Coded Screws
3	013788-45	equip Quarter-Turn Ceramic Cartridge, LTC
4	001019-45	Coupling Nut Washer
5	00AA	1/2" NPT Female Eccentric Flange
6	B-0425-M	1/2" NPT Supply Nipple Kit (2)

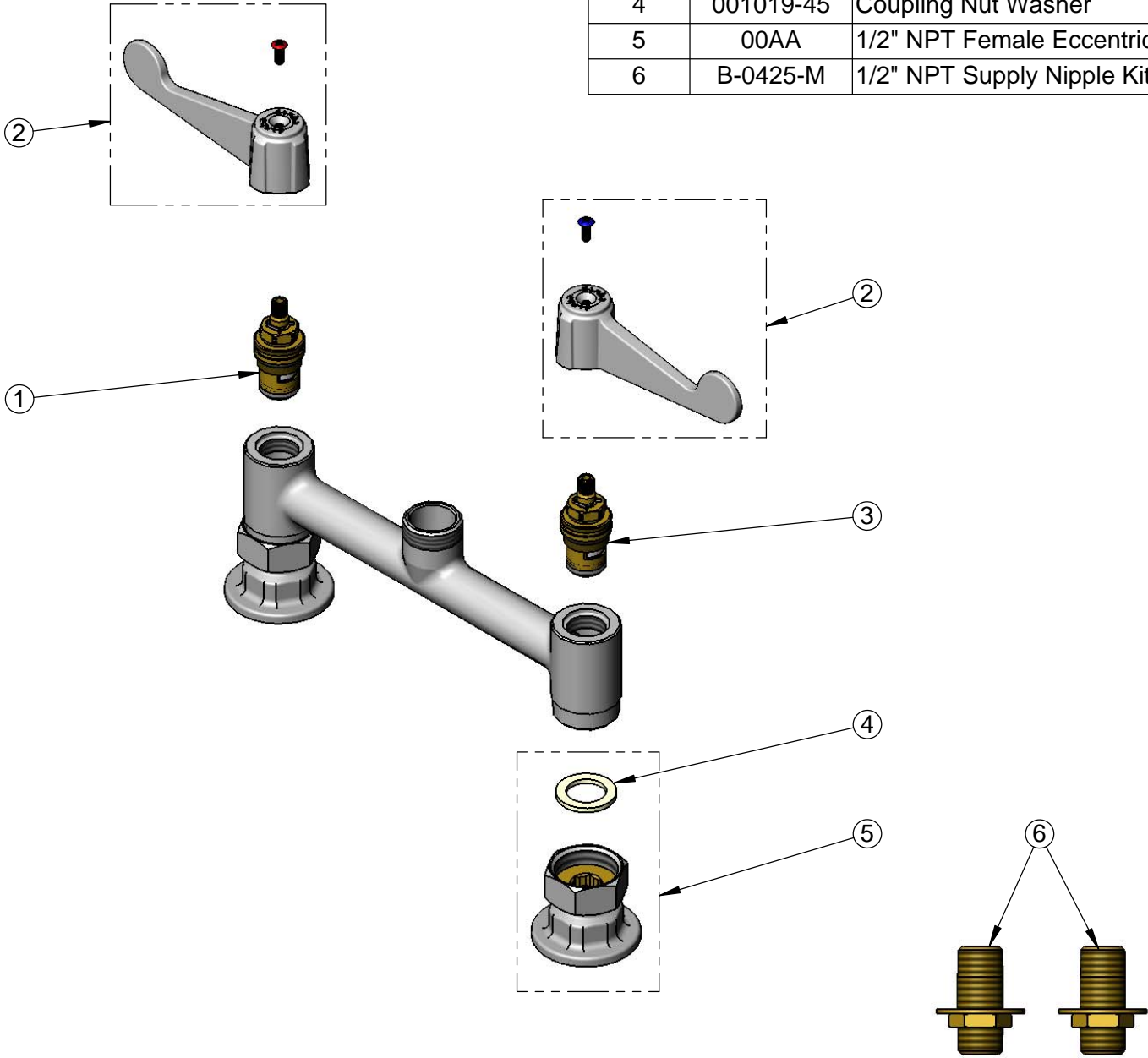

Model Number

**5F-8DWS00**

Product Specifications:

8" Deck Mount Mixing Faucet, Quarter-Turn Ceramic Cartridges, Less Swivel Gooseneck w/ equip 4" Wrist Action Handles & 1/2" NPT Supply Nipple Kits

Product Compliance:

ASME A112.18.1 / CSA B125.1  
NSF 61 - Section 9  
NSF 372 (Low Lead Content)  
ANSI A117.1 (ADA)

equip  
Foodservice  
Accessories

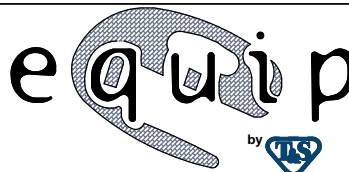

2 Saddleback Cove, P.O. Box 1088  
Travelers Rest, South Carolina 29690  
Phone: 800.891.4808 Fax: 800.868.0084  
equip.tsbrass.com