

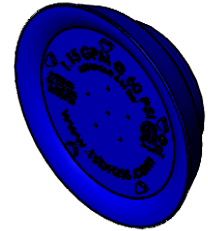

**Architect/Engineering Specifications:**

1.15 GPM spray face with integrated rubber bumper and o-ring. Certified to NSF 61 - Section 9 and NSF 372. 2019 DOE PRSV - Class II Compliant.

Job Name \_\_\_\_\_  
 Model Specified \_\_\_\_\_ Quantity \_\_\_\_\_  
 Variations Specified \_\_\_\_\_  
 Date \_\_\_\_\_

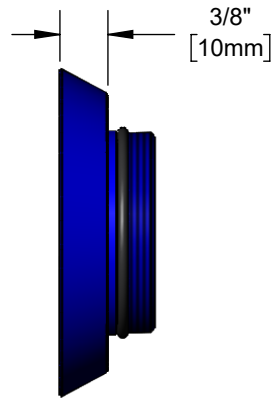
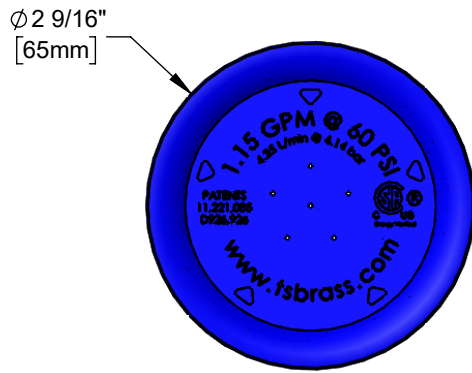

**Features & Benefits:**

- 1.15 GPM spray face with integrated rubber bumper
- O-ring included
- Material: Plastic spray face and rubber bumper

**Product Compliance:**

- NSF 61 - Section 9
- NSF 372 (Low Lead Content)
- 2019 DOE PRSV - Class II



**Warranty:** One Year (Limited)

**Performance Data:**

- Pressure: 20 - 125 psi [1.38 - 8.62 bar]
- Temperature: 40 °F - 140 °F [4.44 °C - 60 °C]
- Flow Rate: 1.15 GPM [ 4.35 L/min] @ 60 psi [4.14 bar]

