

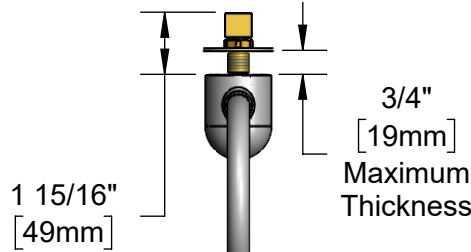

ADA Compliant



3/4"
[19mm]
Maximum
Thickness

1 15/16"
[49mm]

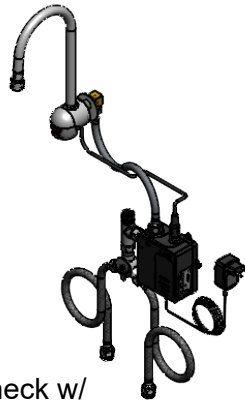

Rigid Gooseneck w/
B-0199-06
VR 2.2 GPM [8.3 LPM]
Aerator & Key. Rigid
Conversion Requires
014200-45 Lock Washer
(Included)

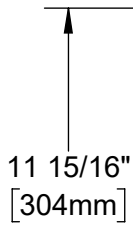

11 15/16"
[304mm]

1/2" NPSM x 3/8" NPSM
x 30" [762mm] Flexible
Stainless Steel Hose

24" [610mm]
Sensor Cable

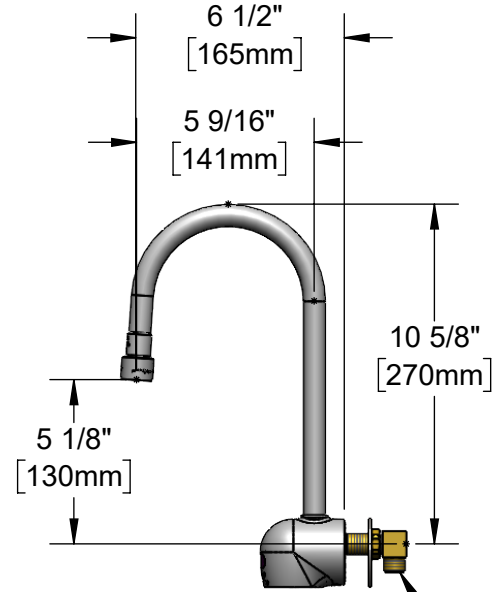

6 1/2"
[165mm]

5 9/16"
[141mm]

10 5/8"
[270mm]

5 1/8"
[130mm]

Short Elbow for Restricted
Space Installations
(Included)

4" x 4 3/8" x 2 3/16" Deep
[102mm x 111mm x 56mm]
Control Module Box
(Black) w/ Water Resistant
Connections. AC or DC
Operated w/ (4) AA Batteries

Removable
Strainer

Mechanical
Mixing Valve
w/ Check
Valves

100-240 VAC Adapter (EU) w/
71" [1800mm] Power Cord.
(Remove Rubber Plug in
Module to Connect)

(2) 1/2" NPSM Female
x 16" [406mm] Flexible
Supply Hoses

(2) 1/2" NPSM Male x
G3/8 Female Adapter
w/ Sealing Washer

Rough-In Requirement:
Ø 1 1/8" [29mm] Mounting Hole

Model Number

5EF-EU1WG-C

Product Specifications:

equip EU Sensor Faucet: Wall Mount Rigid Gooseneck w/
VR 2.2 GPM Aerator, EU Transformer, AC-DC Control Module,
Mechanical Mixing Valve w/ Integral Check Valves &
Flexible Supply Hoses

Product Compliance:

ASME A112.18.1 / CSA B125.1
NSF 61 - Section 9
NSF 372 (Low Lead Content)
ANSI A117.1 (ADA)
UL 1951

equip
Foodservice
Accessories

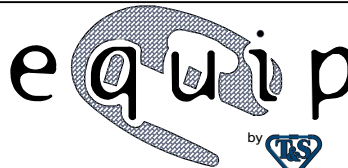

2 Saddleback Cove, P.O. Box 1088
Travelers Rest, South Carolina 29690
Phone: 800.891.4808 Fax: 800.868.0084
equip.tsbrass.com

ITEM NO.	SALES NO.	DESCRIPTION
1	015425-45	Vandal Resistant Key
2	B-0199-06	VR 2.2 GPM Aerator, 55/64-27 Female
* 3	5EF-0004C	Sensor Cable w/Curved Lens
4	016325-45	Flex Connector, 3/8 NPSM x 1/2 NPSM
* 5	5EF-0001C	equip Control Module (Black)
* 6	5EF-0011C	AC Adapter - EU Type Plug
7	016167-45	Supply Hose, 1/2" NPSM Female Ends
8	5EF-0006	Temperature Mixing Valve
9	EC-FILTER	Replacement Filter
10	020498-25	Hex Bushing, G3/8 Female x 1/2" NPSM Male w/ Sealing Washer

* For Versions Prior to 2024, Consult with Customer Service

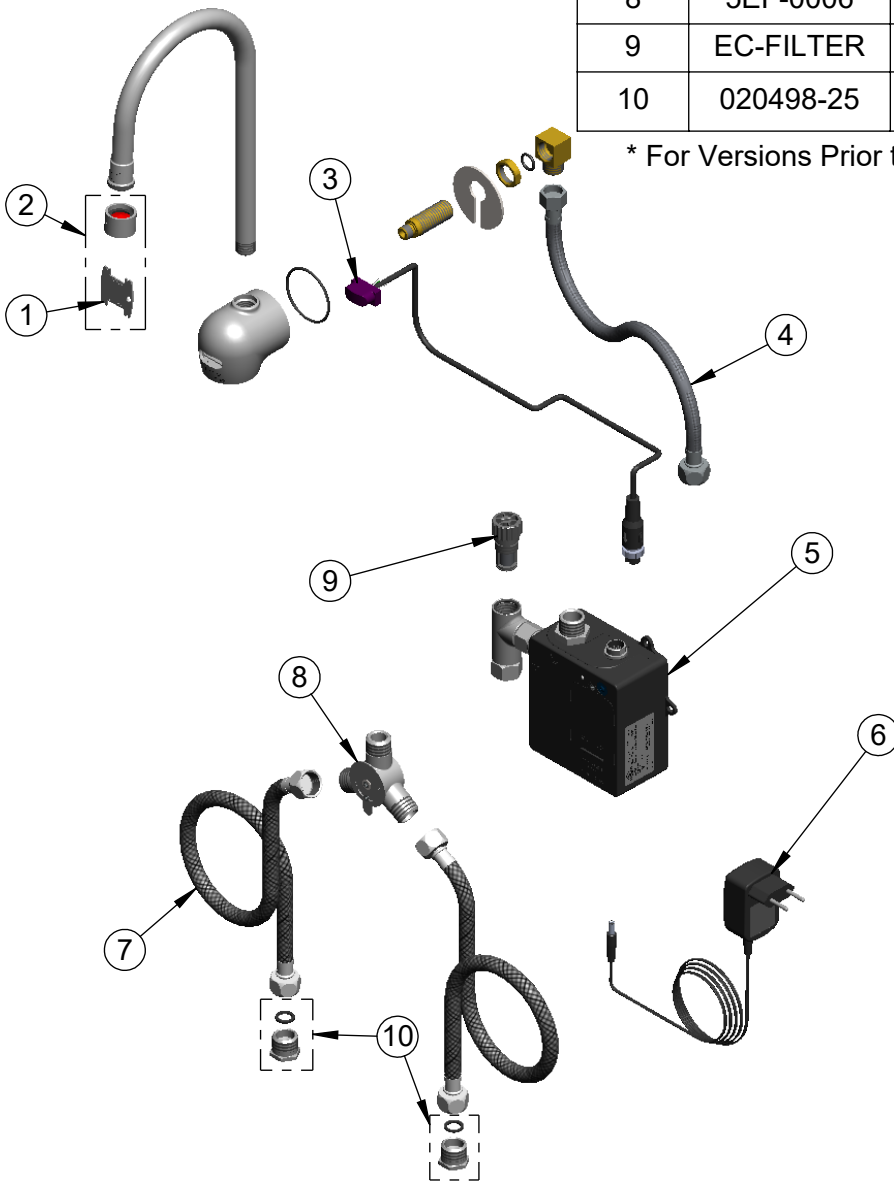

Model Number

5EF-EU1WG-C

Product Specifications:

equip EU Sensor Faucet: Wall Mount Rigid Gooseneck w/
VR 2.2 GPM Aerator, EU Transformer, AC-DC Control Module,
Mechanical Mixing Valve w/ Integral Check Valves &
Flexible Supply Hoses

Product Compliance:

ASME A112.18.1 / CSA B125.1
NSF 61 - Section 9
NSF 372 (Low Lead Content)
ANSI A117.1 (ADA)
UL 1951

equip
Foodservice
Accessories

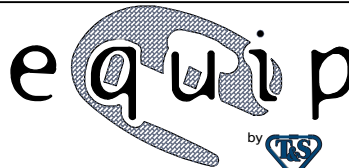

2 Saddleback Cove, P.O. Box 1088
Travelers Rest, South Carolina 29690
Phone: 800.891.4808 Fax: 800.868.0084
equip.tsbrass.com