

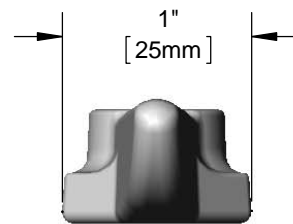

Architect/Engineering Specifications:

Lever handle. Fits all standard T&S compression and ceramic cartridges.

Job Name	_____
Model Specified	_____
Quantity	_____
Variations Specified	_____
Date	_____

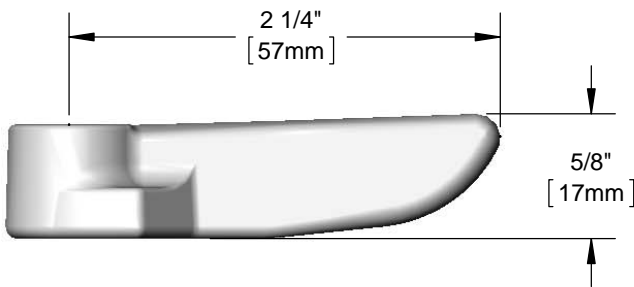

Features & Benefits:

- Lever handle
- Material: Chrome plated metal handle

Product Compliance:

- N/A

Warranty: One Year (Limited)

Performance Data:

- N/A

