



# Swivel Sink and Panty Faucets

## 5F-2SLF06F12

TAG:

### Deck Mount Faucet

#### Architect/Engineering Specifications:

Single hole deck mount faucet with polished chrome plated brass body, 6 1/8" swing nozzle, 1.2 GPM aerator, ceramic cartridges, lever handles, 19 11/16" flexible stainless steel supply hoses with G1/2 swivel female inlets. Certified to ASME A112.18.1\CSA B125.1, NSF 61-Section 9 and NSF 372. Meets ADA ANSI\ICC A117.1 requirements.

Job Name	_____		
Model Specified	_____	Quantity	_____
Variations Specified	_____		
Date	_____		

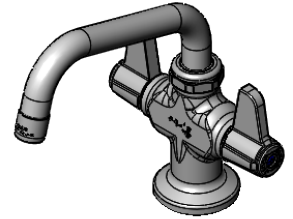
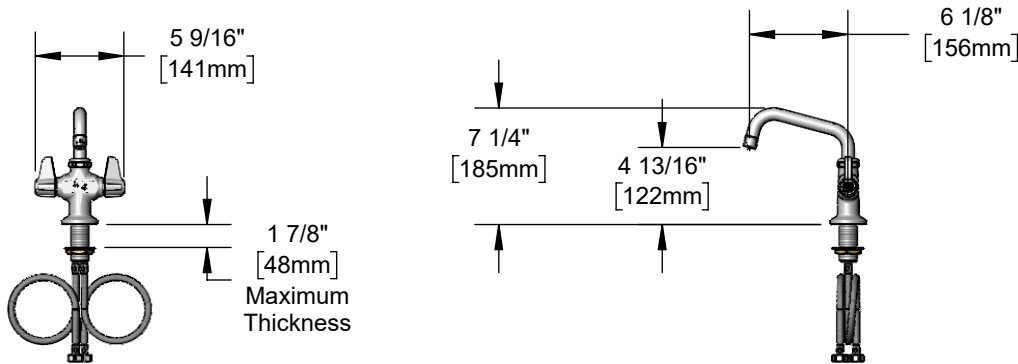

#### Features & Benefits:

- Single hole deck mount mixing faucet w/ polished chrome plated brass body
- 6 1/8" swing nozzle w/ 1.2 GPM aerator
- Quarter-turn ceramic cartridges
- equip lever handles
- 19 11/16" flexible stainless steel supply hoses w/ G1/2 swivel female inlets
- Material: Polished chrome plated brass body and chrome plated metal handles

#### Product Compliance:

- ASME A112.18.1 / CSA B125.1
- NSF 61 - Section 9
- NSF 372 (Low Lead Content)
- ANSI A117.1 (ADA)



**Warranty:** One Year (Limited)

#### Performance Data:

- Pressure: 20 - 125 psi [1.38 - 8.62 bar]
- Temperature: 40 °F - 140 °F [4.44 °C - 60 °C]
- Flow Rate: 1.2 GPM [4.5 L/min] @ 60 psi [4.14 bar]



**ADA Compliant**



equip Foodservice Accessories



• 2 Saddleback Cove • Travelers Rest, SC 29690  
Ph 800-891-4808 • Fax 800-868-0084  
www.tsbrass.com

Date: 07/03/24